

Head Office:
Dixon Kelley Estate Agents
1 Penn Court
Station Road, West Moors
Dorset. BH22 0JJ

DORSET PARK HOMES

DRAFT

www.dorsetparkhomes.com

Telephone: 01202 877511

97 The Crescent, Oaktree Park, St Leonards, Ringwood. BH24 2RP

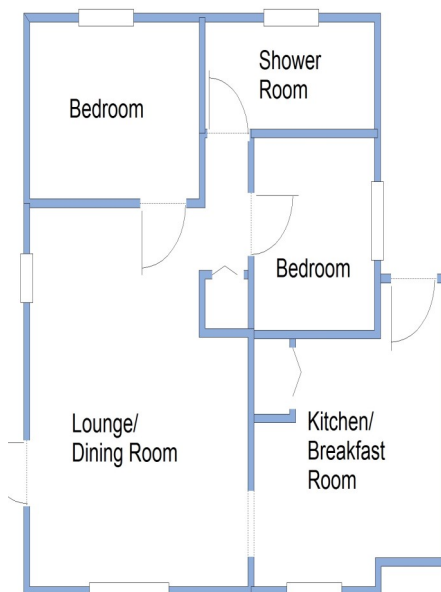

This drawing has been prepared for diagrammatic purpose only. Not to scale.

2-Bedroom Park Home - approx 22' x 20'

Accommodation & approximate room dimensions:

- **Lounge/Dining Room:** approx 14'5" x 11'9". Feature fireplace. Tall storage cupboard.
- **Kitchen/Breakfast Room:** approx 10'9" x 9'6". Range of floor & wall cupboards. Fitted cooker. Plumbing for washing machine. Space for tall fridge/freezer. Cupboard housing combination gas boiler. Ample space for breakfast table. Doors to garden.
- **Bedroom 1:** approx 9'3" x 6'9".
- **Bedroom 2:** approx 7'5" x 6'9".
- **Shower Room:** Large shower cubicle with thermostatic shower fitted. Vanity wash basin & WC.
- Gas Central Heating (system untested)
- PVCu Double-Glazing
- Private Patio Garden with large Shed.
- Parking on Plot
- Age Restriction 50+
- Pets Considered
- Popular Residential Park with active Members Club.
- Well maintained Residential Park between Ferndown & Ringwood. Close to forest walks.

Popular Pet Friendly Park



Pitch Fee: approx £216.57 per month
Subject to annual review
Council Tax Band: 'A' Tenure: 1983 Mobile Homes Act Agreement

Price: £110,000

VIEWING STRICTLY BY APPOINTMENT WITH THE VENDOR'S AGENT Dorset Park Homes 01202 877511

IMPORTANT NOTE: These particulars are believed to be correct but their accuracy is not guaranteed. They do not form part of any contract. Nothing in these particulars shall be deemed to be a statement that the property is in good structural condition or otherwise, nor that any of the services, appliances, equipment or facilities are in good working order or have been tested. Purchasers should satisfy themselves on such matters prior to purchase Ref.W04934

The recommended specialist in Park Home sales
Partner: Simon Dixon

