



School Close, Holmer Green, High Wycombe, Buckinghamshire, HP15 6SR

Asking Price | £3,350

Property Features

- Stunning Detached Family Home
- 'Show Home' Condition
- Five Good Sized Bedrooms
- Two Bathrooms (Master with Ensuite)
- Four Reception Rooms
- Stunning Kitchen/Breakfast Room
- Triple Aspect Living Room
- Level Enclosed Rear Gardens
- Downstairs Cloakroom and Utility Room
- A Lovely Home That Must Be Viewed

Full Description

If you are looking for a wonderful family home, then look no further. This home has everything the modern family is looking for, spacious accommodation over two floors with five great size bedrooms and four reception rooms, as well as a beautifully designed Kitchen/Breakfast Room.

The property is in stunning 'Show Home' condition and offers extremely versatile accommodation. It is also within catchment of the ever-popular Holmer Green primary and secondary schools.

The accommodation of the house comprises; A large modern front door opens to this spacious and inviting entrance hall, superb triple aspect Living Room with doors to the rear and side Decking area, Kitchen/Breakfast Room with Granite work tops with Bosch appliances and modern units which then opens on to a separate Dining Room, Family Room which is great for kids, contemporary Downstairs Cloakroom, and a Study. Downstairs also offers a utility room and access to a large storage room which is ideal for bikes and garden storage. To the first floor there is lovely Master Bedroom with a stunning ensuite bathroom, four further good-sized bedrooms and a modern Family Bathroom.

Outside to the rear there is a level garden, fully enclosed for great security. A large decking area near the house and a bespoke BBQ area with its own patio and brick BBQ with Granite tops which is perfect for entertaining. To the front of the property there is a Brick Paviour Driveway providing parking for up to three cars.

Extra features include double glazing and a recently fitted gas boiler, along with integrated appliances in the kitchen including fridge & freezer, double oven, four ring hob and dishwasher, all finished with an elegant breakfast bar and ceramic flooring. In the Lounge and Master Bedroom there is Rako Lighting control system and USB charging points. Outdoor electrical points and 2 outside taps.





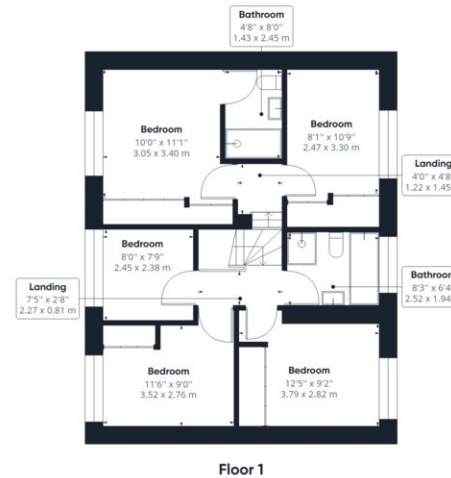
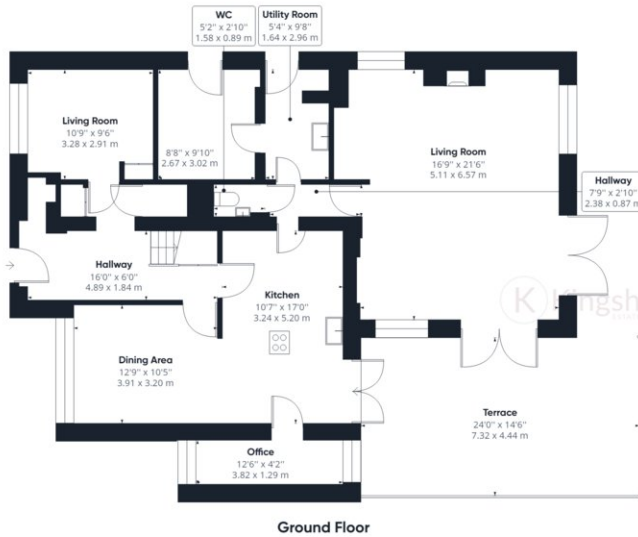

Approximate total area⁽¹⁾

1892.94 ft²

175.86 m²

(1) Excluding balconies and terraces

While every attempt has been made to ensure accuracy, all measurements are approximate, not to scale. This floor plan is for illustrative purposes only.

GIRAFFE360