

Moving You



Blackthorn Walk, Kingswood, BS15 1TZ

07507 189300

£280,000

guy.rolfe@moving-you.co.uk

Freehold

www.moving-you.co.uk









Blackthorn Walk, Bristol, BS15 1TZ

This charming terraced property offers a peaceful oasis with modern decor, three inviting bedrooms, and beautiful views to rear, perfect for a family or couple looking for a serene retreat. Book your viewing today!

Welcome to this charming terraced property that's up for grabs! Situated in a location surrounded by local amenities on Kingswood High Street and delightful green space at Southey Park, this home is in good condition and waiting for the right owner. Whether you're a family seeking a nurturing environment or a couple looking for a serene retreat, this house has everything you need.

As you step inside, you're welcomed by a cosy front reception room, perfect for hosting guests or enjoying a quiet evening in. There is a three piece downstairs shower room for convenience and the heart of the house is the modern kitchen, equipped with modern appliances, where you can whip up delicious meals and create lasting memories.

The property boasts three inviting bedrooms. The master bedroom is a great space with the benefit of fitted wardrobes, offering plenty of space and a peaceful ambiance. The second bedroom is a generous double, ideal for guests or as a child's room. The third bedroom is a comfortable single, perfect for a home office or a cosy personal space.

Externally there is a rear garden ideal and ready for summer barbeques, a garage en-bloc just a short distance from the house with parking in front.

The most striking of all is the beautiful view that this property offers across the rear. You'll find yourself constantly captivated by the far reaching views, providing a sense of serenity that only a home like this can offer.

This friendly neighbourhood, coupled with the quality of the house, makes this an opportunity you don't want to miss. Come and see for yourself what this terraced house has to offer – it might just be the home you've been searching for.

Garage En-bloc - Located a short distance from the property with a parking space in front of the garage.

Council Tax Band B







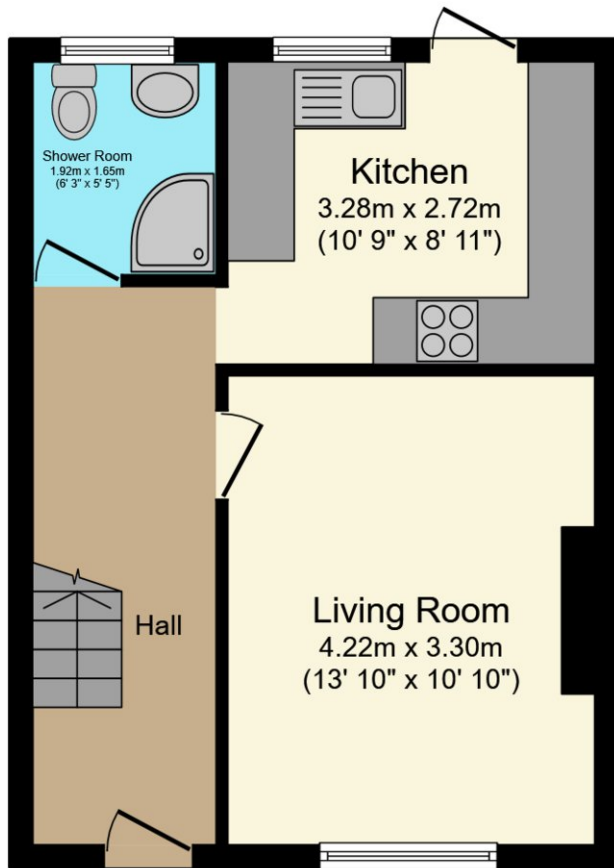

Ground Floor

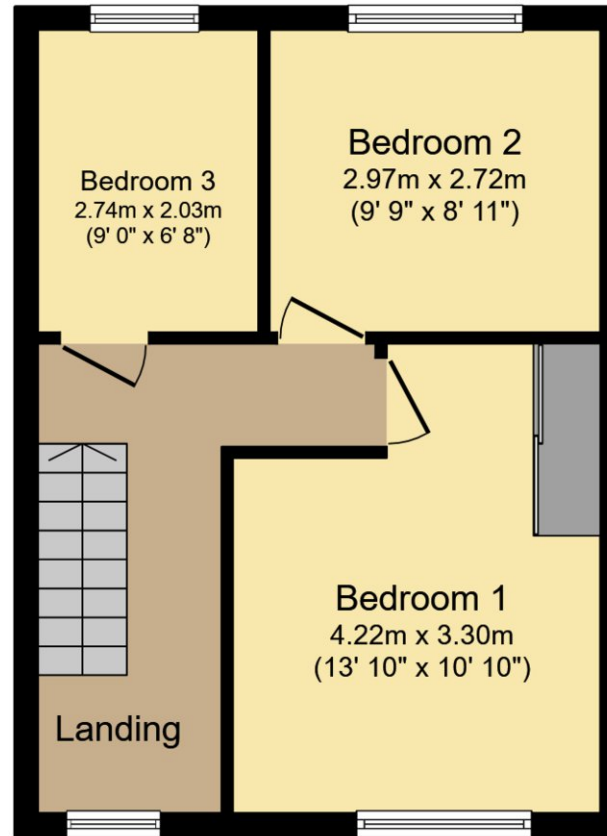

First Floor

This floor plan is for illustrative purposes only. It is not drawn to scale. Any measurements, floor areas (including any total floor area), openings and orientations are approximate. No details are guaranteed, they cannot be relied upon for any purpose and do not form any part of any agreement. No liability is taken for any error, omission or misstatement. A party must rely upon its own inspection(s). Powered by www.Propertybox.io

Guy Rolfe

07507 189300

guy.rolfe@moving-you.co.uk

PROPERTY MISDESCRIPTIONS ACT 1991: The Agents has not tested any apparatus, equipment, fixtures and fittings, or services, so cannot verify that they are in working order or fit for the purpose. The buyer is advised to obtain verification from his or her Professional Buyer, References to the Tenure of the property are based on information supplied by the Vendor. The agents have not had sight of the title documents. The buyer is advised to obtain verification from their Solicitor. You are advised to check the availability of any property before travelling any distance to view.

www.moving-you.co.uk