

Head Office:
Dixon Kelley Estate Agents
1 Penn Court
Station Road, West Moors
Dorset. BH22 0JJ

DORSET PARK HOMES

DRAFT

www.dorsetparkhomes.com

Telephone: 01202 877511

34 Iford Bridge Park, Old Bridge Road, Iford, Bournemouth. BH6 5RQ

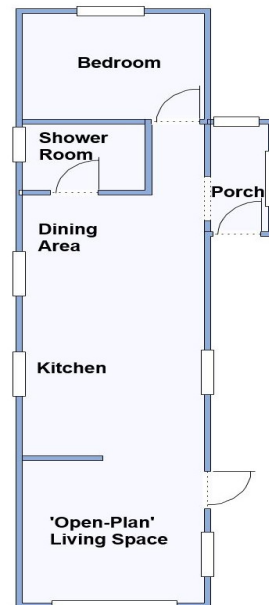

This drawing has been prepared for diagrammatic purpose only. Not to scale

1 Bedroom Park Home approx 40' x 10'

Accommodation & approximate room dimensions:

- Omar Park Home
- Kitchen: approx 11'1" x 9'6". Range of floor cupboards. Freestanding Cooker. Space for fridge/freezer. Integrated washing/drying machine. Breakfast bar.
- Lounge: approx 9'9" x 9'6. Double aspect to front and side.
- Dining Area (formerly Bedroom 2) 9'6" x 6'7": Space for large dining suite.
- Bedroom: approx 9'6" x 7'2". Fitted wardrobes. Window to rear aspect
- Shower Room: Large shower cubicle. Vanity wash basin & WC.
- Gas Central Heating (system untested)
- PVCu Double-Glazing
- Parking on plot for 2 cars
- Delightful Rear Garden. Plastic Shed.
- Age Restriction 50+
- Pet Friendly
- Popular Residential Park close to local amenities & riverside walks. Ideal location between Christchurch & Bournemouth Town Centre. Close to Bournemouth Hospital, major supermarkets, bus & rail links.

Popular 'Pet Friendly' Park



Pitch Fee: approx £220.94 per cal month

Subject to Annual Review

Council Tax Band: 'A'

Tenure: 1983 Mobile Homes Act Agreement

Price £160,000

VIEWING STRICTLY BY APPOINTMENT WITH THE VENDOR'S AGENT Dorset Park Homes 01202 877511

IMPORTANT NOTE: These particulars are believed to be correct but their accuracy is not guaranteed. They do not form part of any contract. Nothing in these particulars shall be deemed to be a statement that the property is in good structural condition or otherwise, nor that any of the services, appliances, equipment or facilities are in good working order or have been tested. Purchasers should satisfy themselves on such matters prior to purchase Ref.W04967

The recommended specialist in Park Home sales
Proprietor: Simon Dixon

