



7 The Warren, Jackson Court, Hazlemere, Buckinghamshire, HP15 7EB

Asking Price | £235,000

Property Description

This beautifully presented 1-bedroom first-floor apartment in the desirable village of Hazlemere, Buckinghamshire, offers modern living with an elegant touch. With its modern design and excellent condition, this apartment is perfect for first-time buyers, professionals, or investors seeking a low-maintenance home.

Constructed in 2018 by a reputable local developer, the apartment boasts contemporary finishes and a thoughtfully designed layout. The property features a spacious double bedroom, a bright and open-plan kitchen/living area, and a useful L-shaped hallway providing extra storage potential. The luxurious fitted bathroom is styled with premium fixtures, providing a spa-like retreat. There is also allocated parking at the property.

Hazlemere is a charming village that combines the tranquility of countryside living with convenient access to local amenities. Enjoy scenic walks through Penn Woods or a game of golf at the well-regarded Hazlemere Golf Club. The village offers an array of shops, cafes, and pubs, while the nearby Wycombe Rye Lido provides leisure opportunities for all ages.

Located just a short drive or bus ride from High Wycombe, residents benefit from larger retail outlets, a vibrant town center, and excellent transport links, including a fast train service to London Marylebone in under 30 minutes. Hazlemere's friendly community and picturesque surroundings make it a sought-after location for those seeking a balance of rural charm and urban convenience.

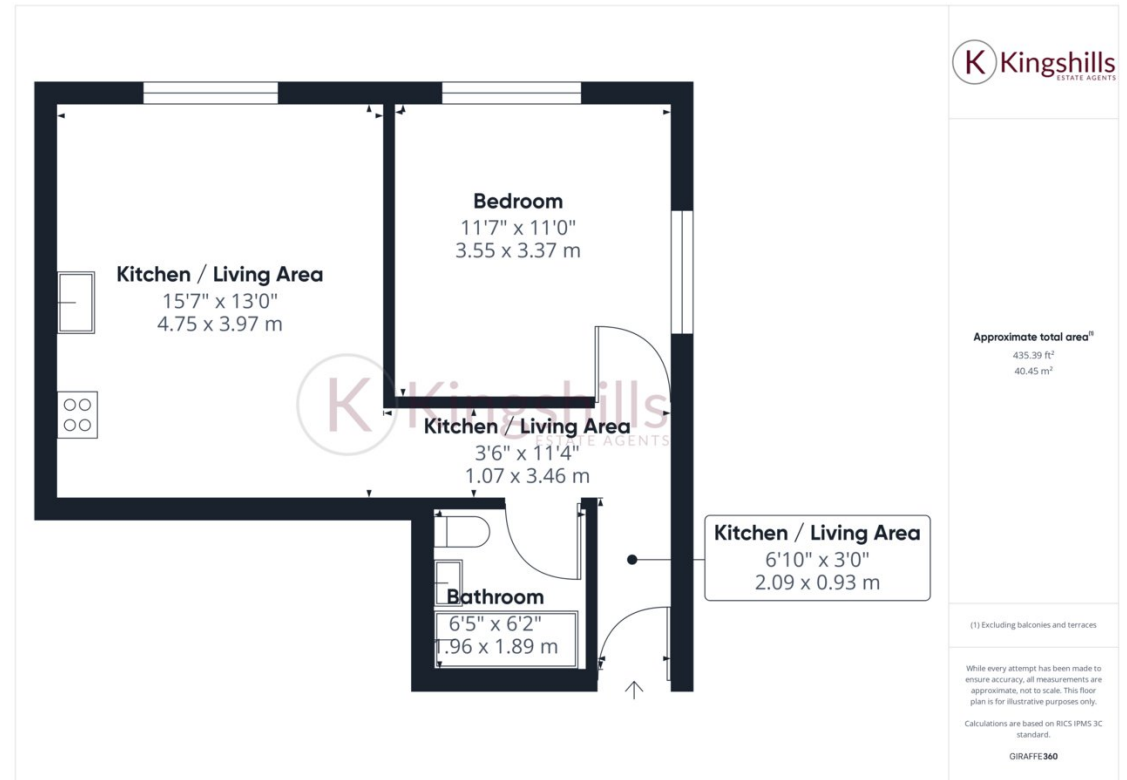

Kingshills Estate Agents
Comet Studios
Amersham
Buckinghamshire
HP7 0PX

01494 939868
hello@kingshills.co.uk
kingshills.co.uk

Agents Note: Whilst every care has been taken to prepare these particulars, they are for guidance purposes only. All measurements are for general guidance purposes only and whilst every care has been taken to ensure accuracy, they should not be relied upon and potential buyers/tenants are advised to recheck the measurements