

# 81 Hastings Crescent, Castleford, West Yorkshire, WF10 3EN



## Features

- 3 Bed Semi Detached House
- Modern Dining Kitchen
- PVCu Double Glazing
- Gas Central Heating
- Newly Landscaped Garden

**Guide Price £165,000 - £175,000**

**rhubarb**  
Sales & Lettings



**\*NO CHAIN\***

This lovely three bedroom semi detached property has recently undergone a scheme of refurbishment both internally and externally.

Offering well proportioned accommodation throughout that is ready to move into. The property boasts PVCu double glazing and gas central heating throughout, with entrance hallway, spacious living room, and modern dining kitchen.

To the first floor there are two double bedrooms, good size third bedroom with built in cabin bed and the house bathroom. Outside the property boasts a driveway and low maintenance garden to the front and rear with artificial lawn.

The property is located within close proximity of Castleford town center, and has easy access to the M62 motorway.

# FLOORPLAN

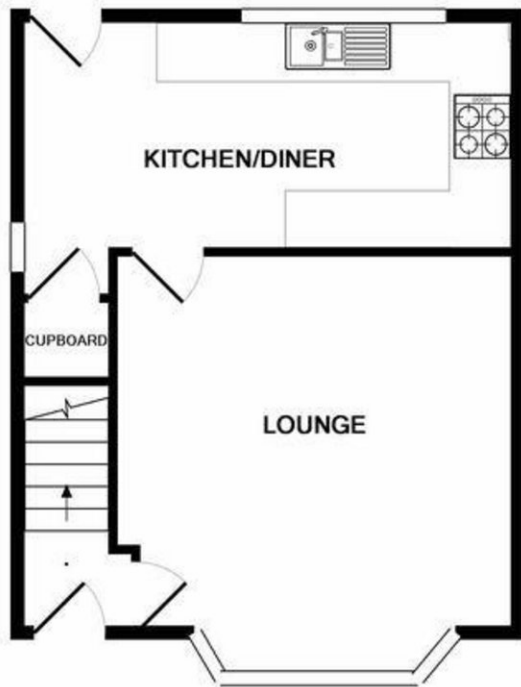

GROUND FLOOR

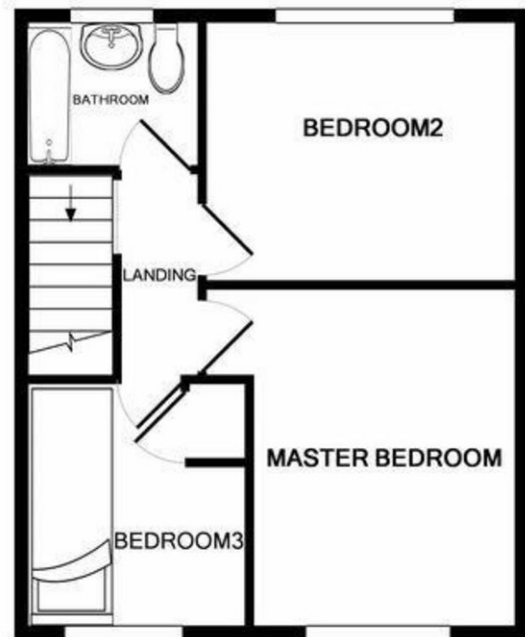

1ST FLOOR

## Wakefield

Shaw Court, Wakefield, West Yorkshire, WF1 4FR  
01924 655 988  
[hello@rhubarbestateagent.co.uk](mailto:hello@rhubarbestateagent.co.uk)

**rhubarb**  
Sales & Lettings