

Head Office:
Dixon Kelley Estate Agents
1 Penn Court
Station Road, West Moors
Dorset. BH22 0JJ

DORSET PARK HOMES

DRAFT

www.dorsetparkhomes.com

Telephone: 01202 877511

42a Selwood Park, Weymans Avenue, Kinson, Bournemouth. BH10 7JU



Well Presented Park Home

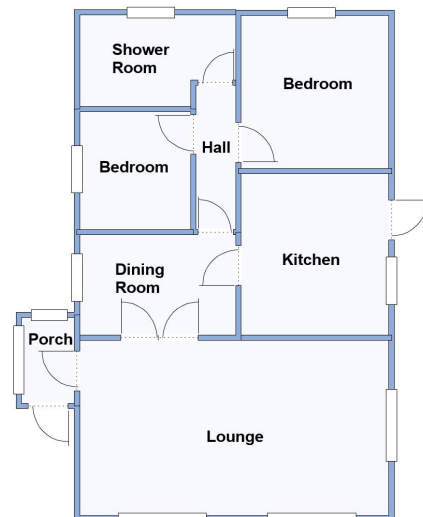

This drawing has been prepared for diagrammatic purpose only. Not to scale

2 Bedroom Park Home approx 32' x 20'

Accommodation & approximate room dimensions:

- Wonderland 'Shaftesbury' Park Home circa 1984
- Entrance Porch
- Lounge: approx 19'6" x 11'. Feature fireplace. 2 bay windows. Double doors to:
- Dining Room: approx 10' x 6'4"
- Kitchen: approx 10'2" x 9'4". Range of base & wall units. Space for cooker, washing machine & fridge/freezer. Cupboard housing combination gas boiler. Door to garden.
- Bedroom 1: approx 9'8" x 9'6" Fitted wardrobes.
- Bedroom 2: approx 7'6" x 7'2".
- Shower Room: modern suite comprising extra large shower cubicle with thermostatic shower. Wash basin & high level WC.
- Gas Central Heating (system untested)
- PVCu Double-Glazing
- Allocated Parking Bay very close to the Park Home
- Small Garden. Concrete Shed.
- Age restriction 50+. 1 Pet Considered
- Popular, well maintained Residential Park close to local amenities & with easy access to Bournemouth & Poole.

Good location close to amenities



Kitchen



Lounge



Popular Park



Dining Room

Pitch Fee: Approx £198.63 per month
Subject to Annual Review
Council Tax Band: 'A'

Tenure: 1983 Mobile Homes Act Agreement

Price £125,000

VIEWING STRICTLY BY APPOINTMENT WITH THE VENDOR'S AGENT Dorset Park Homes 01202 877511

IMPORTANT NOTE: These particulars are believed to be correct but their accuracy is not guaranteed. They do not form part of any contract. Nothing in these particulars shall be deemed to be a statement that the property is in good structural condition or otherwise, nor that any of the services, appliances, equipment or facilities are in good working order or have been tested. Purchasers should satisfy themselves on such matters prior to purchase Ref.W04966

The recommended specialist in Park Home sales
Proprietor: Simon Dixon

