

Head Office:
Dixon Kelley Estate Agents
1 Penn Court
Station Road, West Moors
Dorset. BH22 0JJ

Telephone: 01202 877511

DORSET PARK HOMES

DRAFT

www.dorsetparkhomes.com

68 Hillbury Park, Alderholt, Fordingbridge. SP6 3BW



Spacious Park Home with Garage

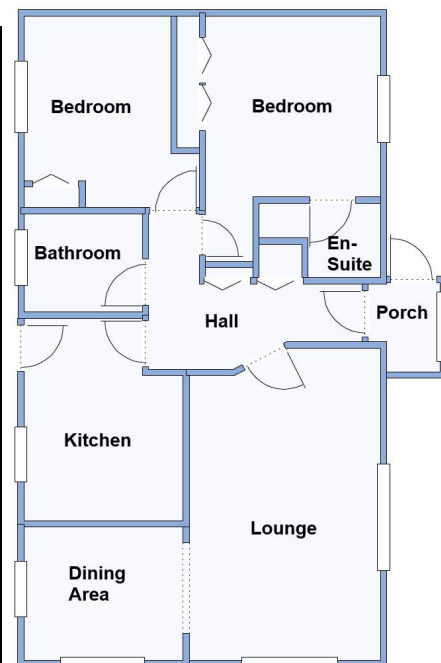

This drawing has been prepared for diagrammatic purpose only. Not to scale.

2-Bedroom Park Home - approx 36' x 20'

Accommodation & approximate room dimensions:

- Wessex 'Dorset' Park Home circa 1998
- Hall: Cloaks cupboard. Linen cupboard. Boiler cupboard housing combination gas boiler (installed 2023). Hatch to roof space.
- Lounge: approx 17'2" x 10'6". Feature fireplace. Bay windows. Archway to:
- Dining Area: approx 8'6" x 7'3". Bay window.
- Kitchen: approx 11'5" x 8'6". Range of floor and wall cupboards. Built-in oven, hob & cooker hood. Space for fridge/freezer & washing machine. Door to garden.
- Bedroom 1: approx 9'7" x 9'6" Plus fitted wardrobe.
- En-Suite Shower Room (Modernised 2022)
- Bedroom 2: approx 10' x 7'6" Built-in wardrobe.
- Bathroom: Panelled bath, wash basin & WC.
- Gas Central Heating (New boiler 2023)
- PVCu Double-Glazing
- Private Garden with sunny aspect. Metal shed.
- Detached Garage & Parking on Plot
- Age Restriction 45+ Pets Considered
- Popular Residential Park in semi-rural location near to local amenities and within a short drive to Fordingbridge town centre.

'Pet Friendly' Park



Kitchen



Lounge



Garage

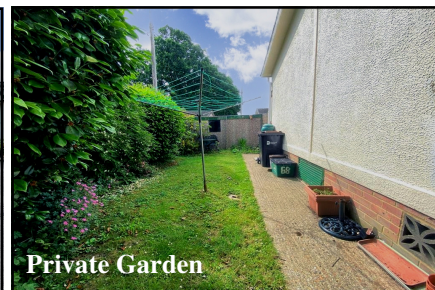

Private Garden

Price: £135,000

VIEWING STRICTLY BY APPOINTMENT WITH THE VENDOR'S AGENT Dorset Park Homes 01202 877511

IMPORTANT NOTE: These particulars are believed to be correct but their accuracy is not guaranteed. They do not form part of any contract. Nothing in these particulars shall be deemed to be a statement that the property is in good structural condition or otherwise, nor that any of the services, appliances, equipment or facilities are in good working order or have been tested. Purchasers should satisfy themselves on such matters prior to purchase Ref.W05071

Pitch Fee: approx £288.29 per month

Subject to Annual Review

Council Tax Band: 'A'

Tenure: 1983 Mobile Homes Act Agreement

The recommended specialist in Park Home sales
Partner: Simon Dixon

