



Property Features

- Stunning Semi Detached Family Home
- 3 Bedrooms
- Potential to Extend STPP
- Beautifully Decorated Throughout
- Extended Modern Kitchen
- Stunning Open Plan Lounge & Dining Room
- Close to Sought After Schools
- Driveway Parking for Several Vehicles
- Garage
- Awaiting EPC / Council Tax Band D

Full Description

Located in the heart of Hazlemere, Buckinghamshire, this exquisite semi-detached house offers a perfect blend of modern comfort and boutique charm. From the moment you arrive, you'll be captivated by its attractive façade, featuring a spacious driveway that can accommodate multiple vehicles, leading to a convenient garage.

Step inside, and you're greeted by an inviting hallway adorned with warm wooden flooring that sets the tone for the rest of the home. The hallway flows seamlessly into the living room, a true highlight of the property, where a real wood fireplace serves as a focal point, providing a cosy ambiance for relaxing evenings. The living room is bathed in natural light, creating a welcoming atmosphere that complements its boutique-style decor.

The living room effortlessly connects to the dining room, where sliding doors open onto a delightful patio area. Perfect for alfresco dining or simply enjoying a quiet moment outdoors, the patio offers a serene space to unwind, with steps leading up to a beautifully terraced garden. The garden features a well-maintained lawn area, ideal for children to play or for hosting garden parties.

Decorated in a classic country style, the charming L shaped kitchen boasts ample worktop space for meal preparation and plenty of cupboard storage to keep everything neatly organised.

Upstairs, you'll find three beautifully appointed bedrooms, each offering its own unique character. The modern family bathroom is a sanctuary of relaxation, featuring both a luxurious bath and a separate shower, catering to all preferences.

This charming semi-detached property beautifully combines chic styling with modern comforts, offering the perfect canvas for you to create your ideal family home.





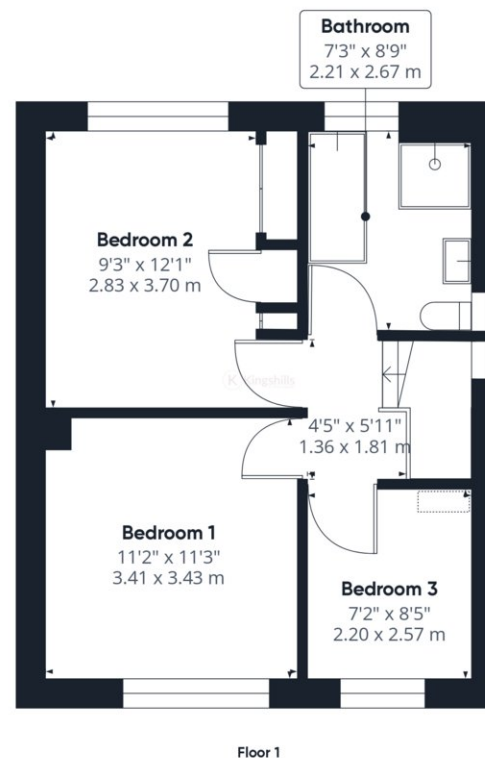
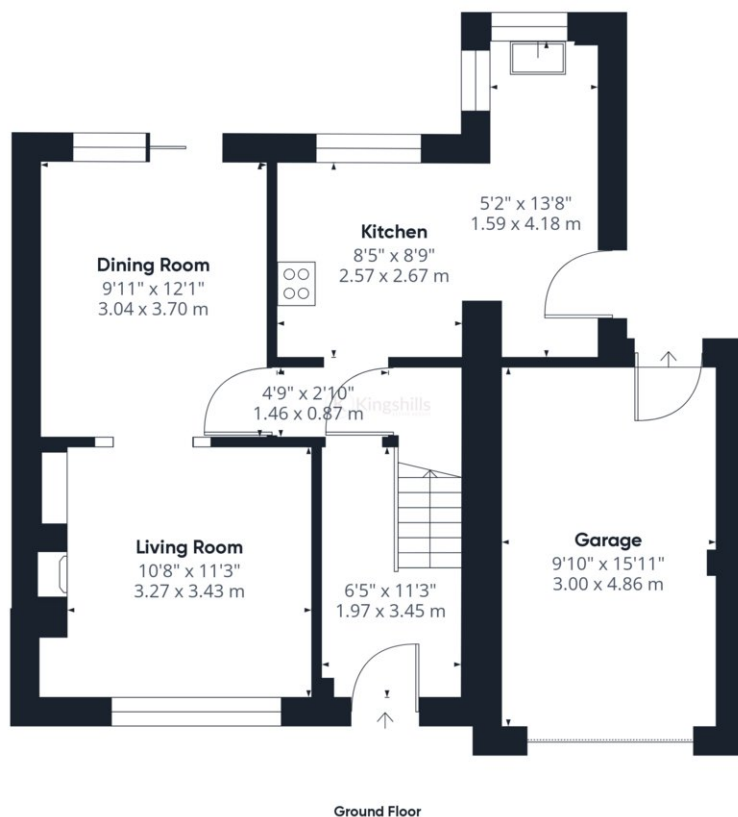

Approximate total area⁽¹⁾

1065.84 ft²
99.02 m²

(1) Excluding balconies and terraces

While every attempt has been made to ensure accuracy, all measurements are approximate, not to scale. This floor plan is for illustrative purposes only.

Calculations are based on RICS IPMS 3C standard.

GIRAFFE360