

Head Office:
Dixon Kelley Estate Agents
1 Penn Court
Station Road, West Moors
Dorset. BH22 0JJ

DORSET PARK HOMES

DRAFT

www.dorsetparkhomes.com

Telephone: 01202 877511

119a Pinehurst Park, West Moors, Ferndown, Dorset. BH22 0BS

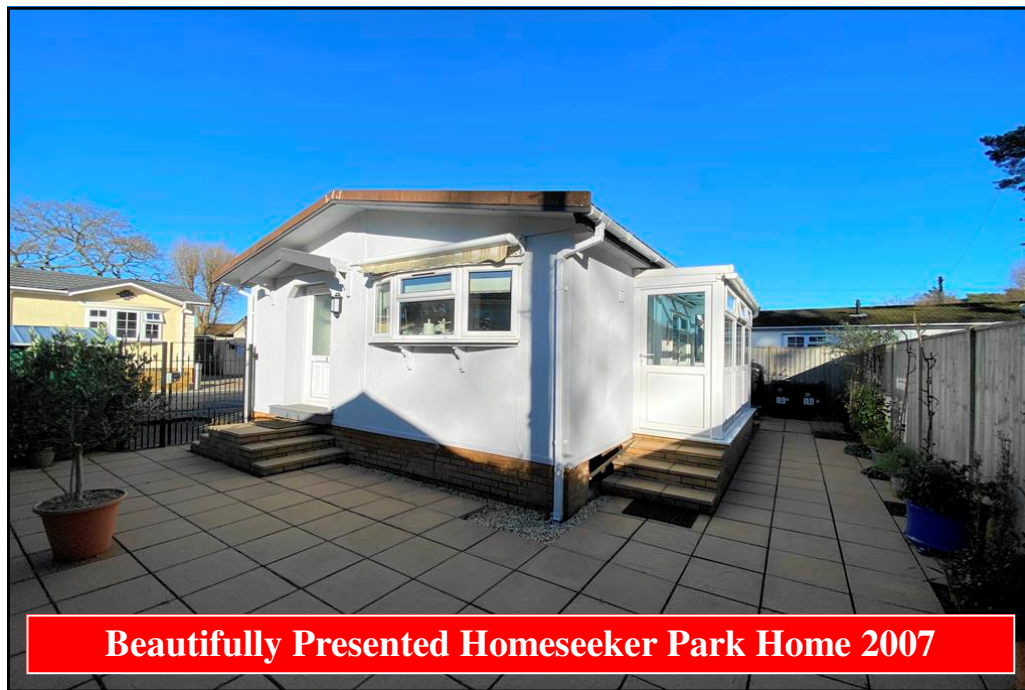

Beautifully Presented Homeseeker Park Home 2007

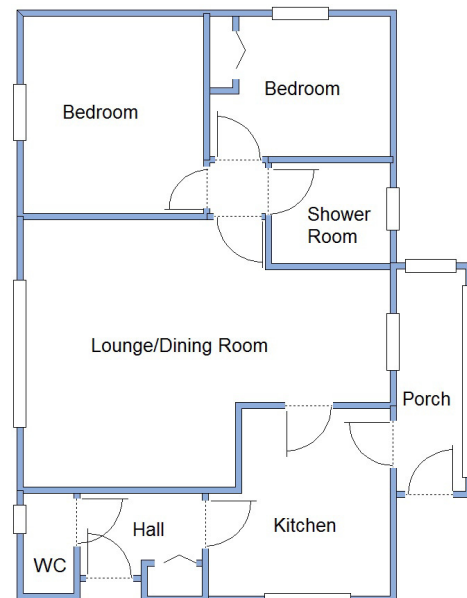

This drawing has been prepared for diagrammatic purpose only. Not to scale

2 Bedroom Park Home approx 31' x 20'

Accommodation & approximate room dimensions:

- **Entrance Hall:** Tall storage cupboard
- **Cloakroom:** WC & wash basin.
- **Kitchen:** approx 10'1" x 9'6" overall max. Range of floor and wall cupboards. Built-in oven, hob & cooker hood. Plumbing for washing machine & dishwasher. Integrated fridge/freezer (untested). Cupboard housing gas fired combination boiler. Door to:
- **Large Side Porch:** Door to garden
- **Lounge/Diner:** approx 19'0" x 14'3" max. Feature fireplace with electric fire fitted (untested).
- **Bedroom 1:** approx 10'4" x 9'6".
- **Bedroom 2:** approx 9'6" x 7'4". Fitted wardrobe.
- **Shower Room:** Large shower with thermostatic shower fitted. Vanity wash basin & WC. Chrome towel rail.
- **Gas Central Heating** (system untested)
- **PVCu Double -Glazing**
- **Delightful Private Garden.** Metal Shed
- **Block Paved Driveway** providing Parking on Plot
- **Age Restriction 45+** Pets Considered
- **Popular Residential Park** near to amenities

Private, Sunny Garden



Pitch Fee: approx £265.28 per month

Subject to Annual Review

Council Tax Band: 'A'

Tenure: 1983 Mobile Homes Act Agreement

PRICE £170,000

VIEWING STRICTLY BY APPOINTMENT WITH THE VENDOR'S AGENT Dorset Park Homes 01202 877511

IMPORTANT NOTE: These particulars are believed to be correct but their accuracy is not guaranteed. They do not form part of any contract. Nothing in these particulars shall be deemed to be a statement that the property is in good structural condition or otherwise, nor that any of the services, appliances, equipment or facilities are in good working order or have been tested. Purchasers should satisfy themselves on such matters prior to purchase Ref.W04958

The recommended specialist in Park Home sales
Proprietor: Simon Dixon

