

Head Office:
Dixon Kelley Estate Agents
1 Penn Court
Station Road, West Moors
Dorset. BH22 0JJ

DORSET PARK HOMES

DRAFT

www.dorsetparkhomes.com

Telephone: 01202 877511

28 Orchid Court, Organford Manor Country Park, Organford, Poole. BH16 6ES

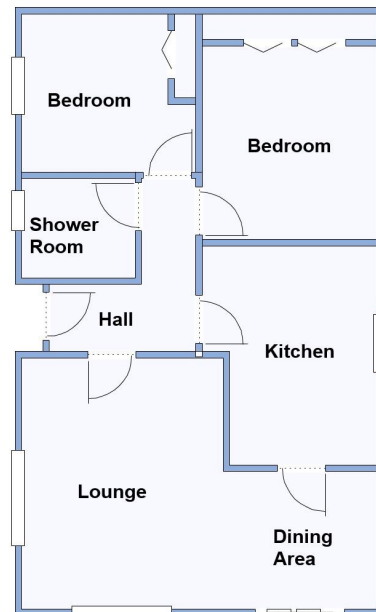

This drawing has been prepared for diagrammatic purpose only.
Not to scale.

Nearly New Park Home in Good Position with Field View

2-Bedroom Park Home - approx 32' x 20'

Accommodation & approximate room dimensions:

- Omar 'Regency' 2023
- Entrance Hall
- Kitchen: Excellent range of floor and wall cupboards. High level oven, hob & cooker hood. Integrated dishwasher, fridge/freezer and washing machine. Cupboard housing combination boiler.
- Lounge/Dining Room: Feature fireplace. Patio doors to raised deck.
- Bedroom 1: Range of fitted wardrobes.
- Bedroom 2: Fitted wardrobes.
- Shower Room: Shower cubicle. Wash basin & WC.
- Gas Central Heating (system untested) & Double-Glazing
- 'On Plot' Parking
- Large raised deck. Metal Shed
- Age Restriction 45+ Pets Considered
- Beautifully maintained 'gated' Residential Park with large dog walking area.
- Within easy reach of Wareham & Poole.

Large Raised Deck



Price: £195,000

Pitch Fee: approx £70.28 per week including Water & Sewerage
Subject to Annual Review

Council Tax Band: 'A'

Tenure: 1983 Mobile Homes Act Agreement

VIEWING STRICTLY BY APPOINTMENT WITH THE VENDOR'S AGENT Dorset Park Homes 01202 877511

IMPORTANT NOTE: These particulars are believed to be correct but their accuracy is not guaranteed. They do not form part of any contract. Nothing in these particulars shall be deemed to be a statement that the property is in good structural condition or otherwise, nor that any of the services, appliances, equipment or facilities are in good working order or have been tested. Purchasers should satisfy themselves on such matters prior to purchase Ref.W04877

The recommended specialist in Park Home sales
Partner: Simon Dixon

