

Head Office:
Dixon Kelley Estate Agents
1 Penn Court
Station Road, West Moors
Dorset. BH22 0JJ

DORSET PARK HOMES

DRAFT

www.dorsetparkhomes.com

Telephone: 01202 877511

3 The Paddock, Oaktree Park, St Leonards, Nr Ringwood. BH24 2RW



Spacious Park Home

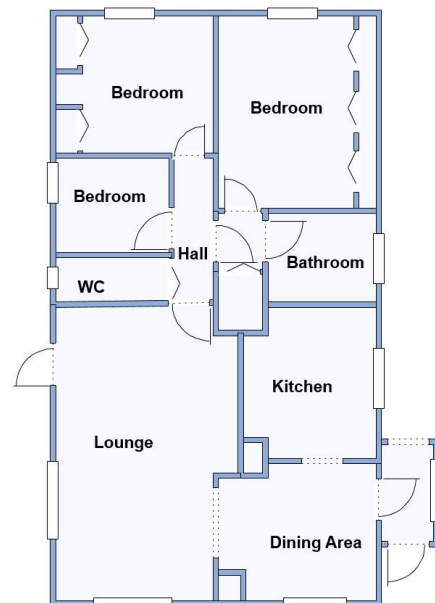

This drawing has been prepared for diagrammatic purpose only. Not to scale.

3-Bedroom Park Home - approx 36' x 20'

Accommodation & approximate room dimensions:

- Twin Unit Park Home approx 1979
- Entrance Porch
- Kitchen: approx 9'1" x 8'4". Modern range of floor and wall cupboards. Cooker point. Space for tall fridge/freezer & washing machine.
- Dining Area: approx 9'5" x 8'7" max. Cloaks cupboard.
- Lounge: approx 18'3" x 11'2" max. Feature fireplace. Door to garden.
- Inner Hall: Cupboard housing Worcester gas boiler & hot water cylinder (untested)
- Bedroom 1: approx 11'7" x 7'8" Plus fitted wardrobes.
- Bedroom 2: approx 9'6" x 8'3". Fitted wardrobes.
- Bedroom 3: approx 7' x 5'8". Fitted wardrobe.
- Bathroom: Panelled bath. Pedestal wash basin. WC.
- Cloakroom: Wash basin & WC.
- Gas Central Heating (system untested)
- PVCu Double-Glazing
- Paved patio garden with Metal Shed
- Parking on Plot
- Age Restriction 50+ Pets Considered
- Well maintained Residential Park with active Members Club. Located between Ringwood & Ferndown.

Popular 'Pet Friendly' Park



Pitch Fee: approx £237 per cal month
Subject to Annual Review
Council Tax Band: 'A' Tenure: 1983 Mobile Homes Act Agreement

Price: £120,000

VIEWING STRICTLY BY APPOINTMENT WITH THE VENDOR'S AGENT Dorset Park Homes 01202 877511

IMPORTANT NOTE: These particulars are believed to be correct but their accuracy is not guaranteed. They do not form part of any contract. Nothing in these particulars shall be deemed to be a statement that the property is in good structural condition or otherwise, nor that any of the services, appliances, equipment or facilities are in good working order or have been tested. Purchasers should satisfy themselves on such matters prior to purchase Ref.W04844

The recommended specialist in Park Home sales
Partner: Simon Dixon

