

KILBURN  
THREE  
BEDROOM  
HOME

BLOOR HOMES



A three bedroom semi-detached home with spacious lounge and fantastic open plan kitchen / dining area featuring French doors leading to the garden. Upstairs the master bedroom benefits from an en suite shower room.

KILBURN

A BEAUTIFUL THREE BEDROOM  
SEMI-DETACHED HOME

**KILBURN  
THREE  
BEDROOM  
HOME**

**FIRST FLOOR:**

**BEDROOM 1**  
3.10m x 3.38m  
10'2" x 11'1"

**EN SUITE**

**BEDROOM 2**  
2.57m x 2.94m  
8'5" x 9'8"

**BEDROOM 3**  
2.10m x 2.76m  
6'11" x 9'1"

**BATHROOM**

**GROUND FLOOR:**

**LOUNGE**  
3.75m x 4.75m  
12'3" x 15'7"

**KITCHEN / DINING**  
3.63m x 3.69m  
11'11" x 12'1"

**UTILITY**  
1.05m x 1.70m  
3'5" x 5'7"

**CLOAKS**



**GROUND  
FLOOR**

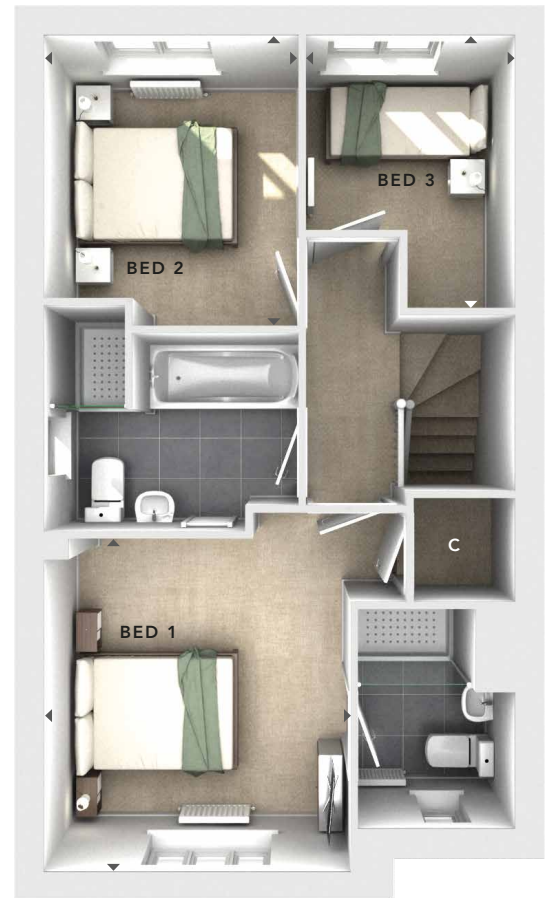

**FIRST  
FLOOR**

<b>C</b>	- Storage
△	- External Access
◀▶	- Measurement Points
<b>386 RENDER 4.12</b>	