

Head Office:
Dixon Kelley Estate Agents
1 Penn Court
Station Road, West Moors
Dorset. BH22 0JJ

DORSET PARK HOMES

DRAFT

www.dorsetparkhomes.com

Telephone: 01202 877511

26 Handley Park, Sixpenny Handley, Salisbury, Wilts, SP5 5PL

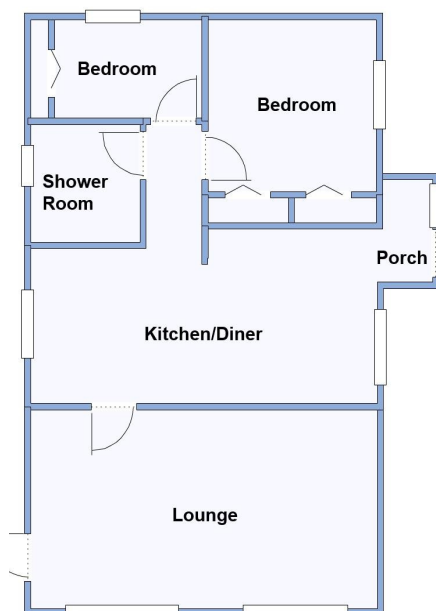

This drawing has been prepared for diagrammatic purpose only. Not to scale.

2-Bedroom Park Home - approx 32' x 20'

Accommodation & approximate room dimensions:

- **Porch:** Space for tumble dryer. Door to garden.
- **Kitchen/Dining Area:** approx 19'2" x 9'2" max. Modern kitchen with range of floor and wall cupboards. Freestanding oven with gas hob. Space for washing machine & counter fridge/freezer. Larder cupboard. Wall mounted gas combination boiler. Space for dining table. Door leading to:
- **Lounge:** approx 19'2" x 10'4". Feature electric fireplace. Door leading to Drive.
- **Bedroom 1:** approx 9'8" x 9'2". Fitted wardrobes.
- **Bedroom 2:** approx 9'5" x 5'2". Fitted wardrobe.
- **Bathroom:** Panelled walk-in bath. Wash basin & WC.
- **Delightful Private Garden.**
- **Gas Central Heating** (system untested) **LPG Gas.**
- **PVCu Double-Glazing**
- **Parking on Plot**
- **Age Restriction 55+**
- **Pets Considered**
- **Small Residential Park in Village Centre Location** close to local convenience store & bus services.

Delightful Village Park

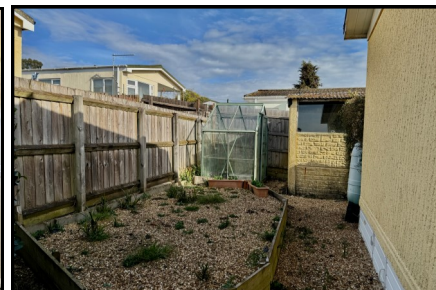

Pitch Fee: approx £136.71 per month

Subject to Annual Review

Council Tax Band: 'A'

Tenure: 1983 Mobile Homes Act Agreement

Price: £100,000

VIEWING STRICTLY BY APPOINTMENT WITH THE VENDOR'S AGENT Dorset Park Homes 01202 877511

IMPORTANT NOTE: These particulars are believed to be correct but their accuracy is not guaranteed. They do not form part of any contract. Nothing in these particulars shall be deemed to be a statement that the property is in good structural condition or otherwise, nor that any of the services, appliances, equipment or facilities are in good working order or have been tested. Purchasers should satisfy themselves on such matters prior to purchase Ref.W05005

The recommended specialist in Park Home sales
Partner: Simon Dixon

