

HOME



Chelmsford
Offers Over £165,000
1-bed apartment

Chelmsford
11 Duke Street
Essex CM1 1HL

thehomepartnership.co.uk

Sales
01245 250 222
Lettings
01245 253 377
Mortgages
01245 253 370

Primrose Hill

Situated in a convenient location approximately 0.5 miles from the railway station is this one bedroom first floor apartment. The accommodation comprises an entrance lobby with a staircase to the first floor landing. There is a lounge as well as a kitchen which is fitted with a range of base and eye level units including a fitted oven and a four ring hob. There is a double bedroom and a bathroom WC. This property comes with an allocated parking space and has gas fired central heating and is offered for sale with no onward chain.

Situated just 0.5 mile walk to the railway station with trains to London Stratford from 31 minutes and Liverpool Street from 36 minutes. The City centre itself has two large shopping malls and a pedestrianised high street home to a mix of national and international stores, places to eat, drink and socialise. The new Bond Street shopping complex has a John Lewis department store, an Everyman Cinema an a range of restaurants, eateries and bars next to the river.

First Floor

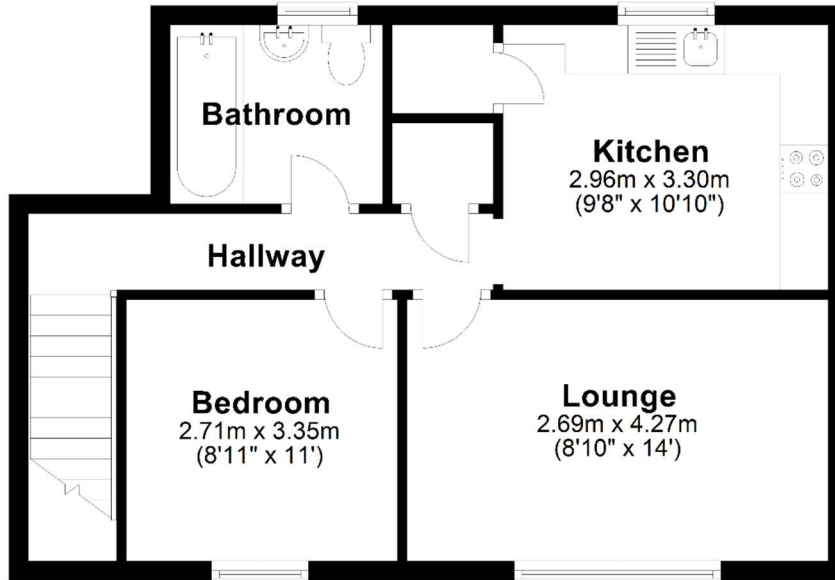

Features

- No onward chain
- Gas radiator central heating
- Allocated parking bay
- 0.5 mile walk of the railway station
- Close to Admirals park
- Ideal buy to let investment
- One bedroom apartment
- Approx. 1 mile from the City centre & station

EPC Rating

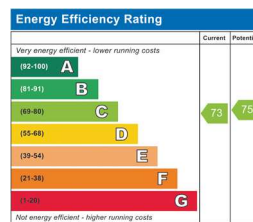

The Nitty Gritty

Tenure: Leasehold

Band B is the Council Tax band for this property with an annual bill of £1,547.28

Lease length: 125 years from 24/6/1987, expiring on 23/6/2112.

Ground rent: £50 pa

Service charge: For 1/1/2023 to 31/12/2023 is £1213.64 which can be paid quarterly. The service charge is reviewed annually.

As an integral part of the community, we've gotten to know the best professionals for the job. If we recommend one to you, it will be in good faith that they'll make the process as smooth as can be. Please be aware that a small number of the parties we recommend (certainly not the majority) may on occasion pay us a referral fee up to £200. You are under no obligation to use a third party we have recommended.

