



Property Features

- CHARACTER SEMI DETACHED
- CLOSE TOWN & STATION
- UPDATED DECOR
- ORIGINAL FIREPLACES, TALL CEILINGS
- TWO RECS & 3 BEDROOMS
- ENCLOSED REAR GARDEN
- BACKS ONTO LOCAL PARK
- NO ONWARD CHAIN

Full Description

A period style three bedroom semi-detached house which has recently been redecorated. The property backs onto a local park and is situated within a short walk from Maidenhead town centre and mainline train station (Elizabeth line). This fine property is offered with no chain above.

The Property:

Entrance hall, downstairs cloakroom, two reception rooms, kitchen, 3 bedrooms, bathroom, parking and an enclosed rear garden. Many character features through the home.

Maidenhead:

This home backs onto Grenfell Park. Maidenhead itself offers a comprehensive range of shopping and recreational facilities. The region is well served for sporting/leisure facilities including the David Lloyd Centre and Braywick Leisure Centre. There is a wealth of good local schools.

Transport Links:

By Rail, The Elizabeth line in Maidenhead provides regular trains to London Paddington.

By Road, Connections are excellent with the M4, available via junction 8/9 providing access Heathrow, Central London, the West Country and the M25. The M40 may be reached via the Marlow-By-Pass A404, accessed at Maidenhead Thicket.

COUNCIL TAX BAND - C

EPC RATING - E/42



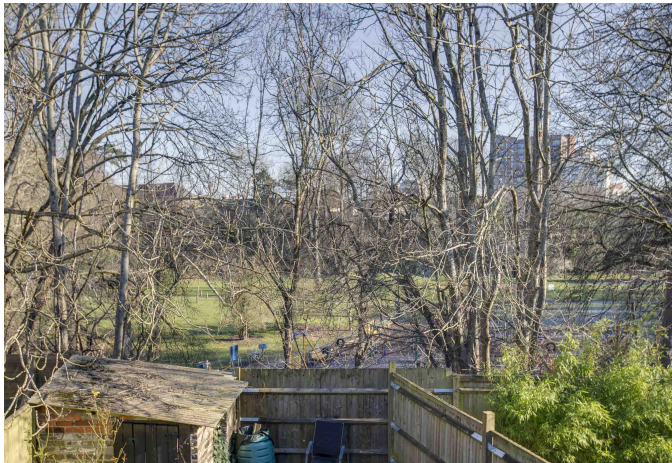

Grenfell Road

Approximate Gross Internal Area
Ground Floor = 51.1 sq m / 550 sq ft
First Floor = 51.9 sq m / 559 sq ft
Store = 4.4 sq m / 47 sq ft
Total = 107.4 sq m / 1156 sq ft

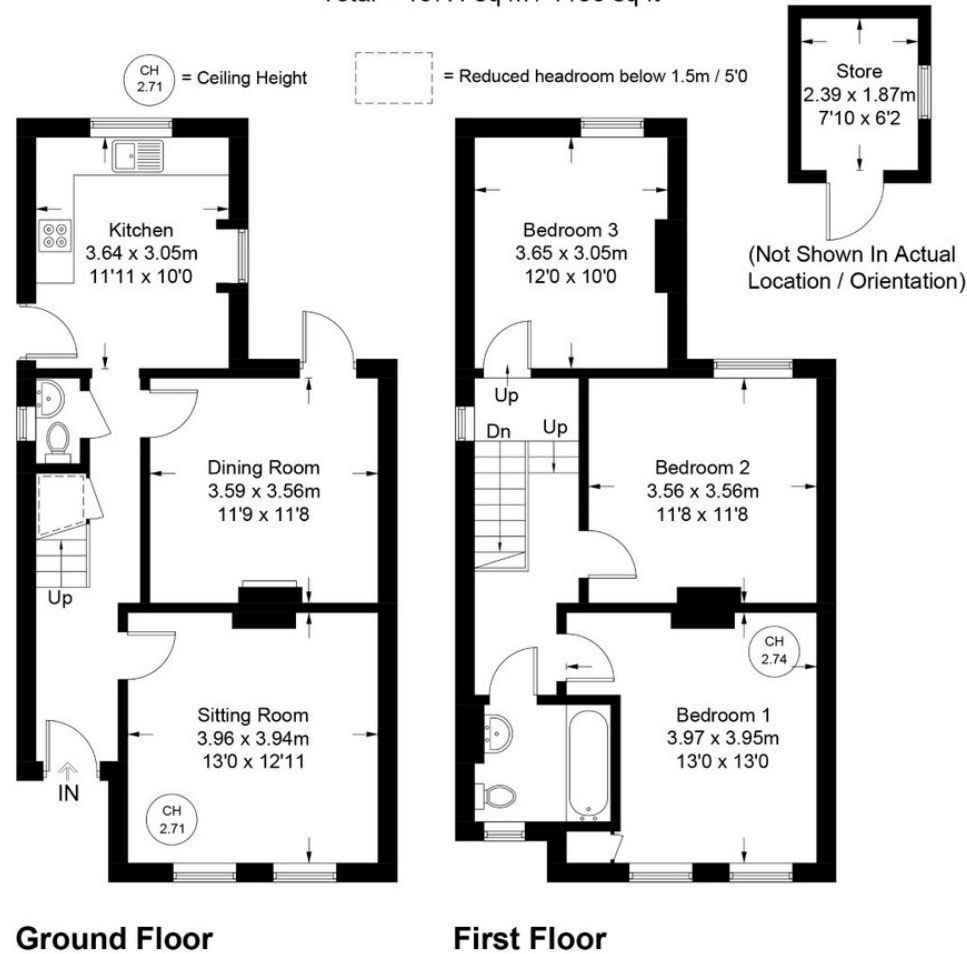

Floor Plan produced for Kingshills by Media Arcade ©.

Illustration for identification purposes only. Window and door openings are approximate. Whilst every attempt is made to assure accuracy in the preparation of this plan, please check all dimensions, shapes and compass bearings before making any decisions reliant upon them.

Kingshills Estate Agents
Covering Marlow
Bourne End, Maidenhead
& Surrounds

01628 561222
davidandsusan@kingshills.co.uk
kingshills.co.uk

Agents Note: Whilst every care has been taken to prepare these particulars, they are for guidance purposes only. All measurements are for general guidance purposes only and whilst every care has been taken to ensure accuracy, they should not be relied upon and potential buyers/tenants are advised to recheck the measurements