



CITY PRIME
P R O P E R T I E S

PRESENTS

RODNEY COURT, MAIDA VALE , LONDON W9



RODNEY COURT

Prime Refurbishment Opportunity!
Spacious Three-Bedroom Apartment With Private Balcony.

A chance to secure a rare gem in a prime location! This spacious three-bedroom, two-bathroom apartment is awaiting a makeover to become someone's dream home or a great project.

- Three Bedroom
- Two Bathroom
- In Need of Modernisation
- Private Balcony
- High Ceiling
- First Floor
- Eat-in Kitchen
- First Floor
- Lift
- Full of Character
- Long Lease
- 1100 SqFt
- Great Storage
- Moments from Tube Station
- Minutes by bus to Hyde Park
- Minutes by bus to Oxford Street
- Chain Free
- Porter 24/7



Rodney Court is a beautiful period building built in 1915. It features lots of character and offers fantastic living accommodations. Located 7 min walk from Maida Vale Tube Station and minutes of vibrant cafes and shops on Clifton Road.



This spacious three-bedroom, two-bathroom apartment is awaiting a makeover to become your dream home. Situated on the first floor of a charming period building from 1915, this property offers ample space and potential. Features include high ceilings, a private balcony, and access to a lift and 24/7 porter services. With a long lease, convenience is guaranteed. The apartment is ideally located close to vibrant Clifton Street and famous Oxford Street, with Warwick underground station nearby for easy commuting.





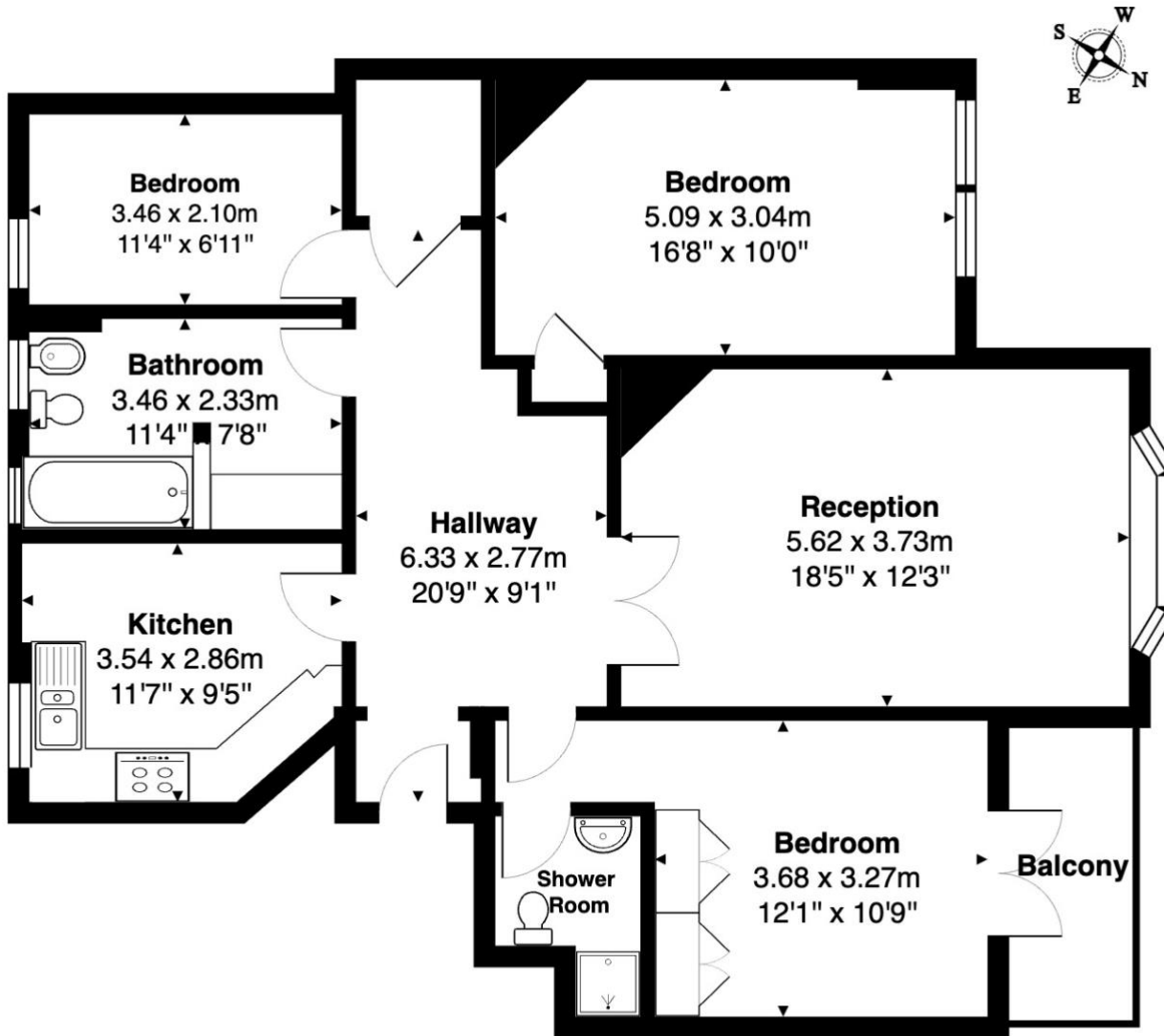

First Floor

Total Area: 99.5 m² ... 1071 ft² (excluding balcony)

All measurements are approximate and for display purposes only.

| Energy Efficiency Rating | | Current | Potential |
|---|----------|---------|-----------|
| Very energy efficient - lower running costs | | | |
| (92 plus) | A | | |
| (81-91) | B | | 83 |
| (69-80) | C | | |
| (55-68) | D | 66 | |
| (39-54) | E | | |
| (21-38) | F | | |
| (1-20) | G | | |
| Not energy efficient - higher running costs | | | |



**Viewings strictly by appointment.
Please contact our agent Bozena Dela**

3rd Floor Albemarle Street,
Mayfair, London
London W1S 4JL

M: + 44 (0) 7863172705
T: + 44 (0) 203 7277977



cpp@cityprimeproperties.co.uk



www.cityprimeproperties.co.uk

