

Head Office:
Dixon Kelley Estate Agents
1 Penn Court
Station Road, West Moors
Dorset. BH22 0JJ

DORSET PARK HOMES

DRAFT

www.dorsetparkhomes.com

Telephone: 01202 877511

132 East Drive, Oaktree Park, St Leonards, Ringwood BH24 2RS



Well Presented Park Home on Good Plot

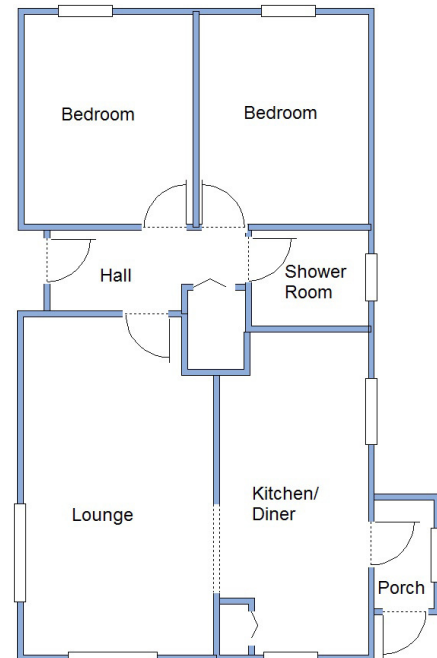

This drawing has been prepared for diagrammatic purpose only. Not to scale.

2-Bedroom Park Home - approx 36' x 20'

Accommodation & approximate room dimensions:

- Stately Albion 'Balmoral' 1983
- Hall: Storage cupboard. Laminate flooring.
- Lounge: approx 18'8" x 10'9". Bay window. Feature fireplace with electric fire.
- Kitchen/Diner: approx 18' x 8'3". Comprising a good range of floor and wall cupboards. Built-in high level oven & microwave. Gas hob. Space for dishwasher & tall fridge/freezer. Ample space for dining suite. Laminate flooring.
- Porch: Plumbing for washing machine.
- Bedroom 1: approx 11'8" x 9'4". Fitted wardrobes.
- Bedroom 2: approx 11'8" x 9'4". Fitted wardrobes.
- Shower Room: Shower cubicle with electric shower. Vanity Wash basin & WC.
- Gas Central Heating (Complete New System 2022)
- Large Garden predominantly laid to patio with shrubs & evergreens. Greenhouse. Rear gate.
- Parking on Plot
- Age Restriction 50+ Pets Considered
- Popular, well maintained Residential Park with active members club. Convenience store & Gym on nearby holiday park.

Popular 'Pet Friendly' Park



Price: £149,950

Pitch Fee: approx £216.57 per month

Subject to Annual Review

Council Tax Band: 'A'

Tenure: 1983 Mobile Homes Act Agreement

VIEWING STRICTLY BY APPOINTMENT WITH THE VENDOR'S AGENT Dorset Park Homes 01202 877511

IMPORTANT NOTE: These particulars are believed to be correct but their accuracy is not guaranteed. They do not form part of any contract. Nothing in these particulars shall be deemed to be a statement that the property is in good structural condition or otherwise, nor that any of the services, appliances, equipment or facilities are in good working order or have been tested. Purchasers should satisfy themselves on such matters prior to purchase Ref.W04908

The recommended specialist in Park Home sales
Partner: Simon Dixon

